



## TECHNICAL DATA SHEET

FFP2 Mask without valve

The respirator provides protection against harmful substances such as solid and liquid dusts, smoke and aerosols (FFP2). It filters at least 94% of bacteria, dust, chemicals, particles, pollen and smoke.

## KSI CARE SERIE

FFP2 Mask without valve

KSi Article No.: 128-KSI-Care-FFP2-Easewell

## CERTIFICATIONS / PRODUCT-RELATED STANDARDS

Easewell brand masks meet the following standards

Standards: EN 149:2001 + A1:2009 according to (EU) regulation on PPE

(personal protective equipment, 2016/425

CE conform (notified body CE2834)

Type of individual packaging: Polybag

Type of EIS: Design board

Country of production: People's Republic of China

## PRODUCT DESCRIPTION / MATERIAL

- PP Non-Woven and melt blown filter material
- 3-layer filter
- Particulate filter efficiency (PFE) >94%
- Fine dust filtration (PM 2, 5)
- 3D Design, latex free, uni size
- breathable, effortless inhalation and exhalation
- easily mouldable nose clip with PE coating for perfect fit
- Weight: approx. 10g
- Size: 10,7 x 15,5 cm
- Colour: white



## FEATURES

- **Nose seal lip:**  
The nose sealing lip improves the sealing fit
- **Flexible material:**  
The masks have a strong and durable outer structure.
- **Foldable:**  
combines all the advantages of our classic masks, but is easier to transport. Ready to carry in one go.
- **Individually packed:**  
Protected from dust and dirt, hygienically packed until use.

NR (non reusable) = Single use.

Comfortable and dimensionally stable throughout the shift.

## AREAS OF APPLICATION

clinical or civil use

## PACKAGING

Quantity inner packaging	10 pieces per UVE
Quantity outer carton	800 pieces in master carton
Full pallet	11,200
L x W x H Outer box in cm	65.6 x 52.5 x 27.8
Volume in m <sup>3</sup> outer carton	0,0957
Gross weight outer box in Kg.	8,5

## PRODUCT FEATURES

customs tariff number	63079098990
Minimum shelf life	2 years

## SETUP INSTRUCTIONS

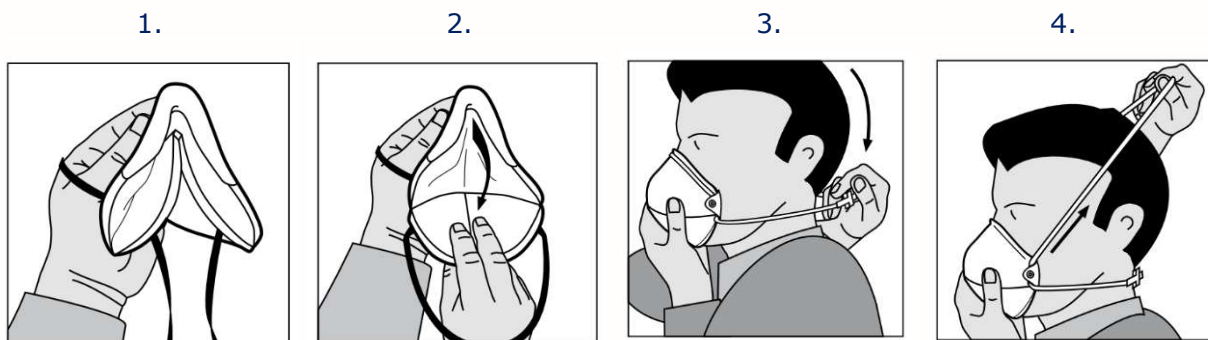

**Test:** Before use, determine whether the respiratory protection is suitable for the intended use. Ensure that the mask is worn correctly. Before use, the user must be trained in the correct handling of the product in accordance with national regulations.

How to put the mask on: Hold the mask shell in one hand (1), with the nose clip at your fingertips, the headgear hanging under the hand (2). Put the mask on under the chin with the nose bridge up. Pull the upper band onto the back of the head, the lower one under the ears (3/4). The straps must not be overtightened. Use both hands to adjust the noseband to the shape of your nose to achieve a good seal. If the noseband is pressed with only one hand, a wrinkle may form, which makes the seal worse. The seal of the mask on the face should be checked before entering the workplace.

**Do you need more detailed information? We will be happy to advise you!**

The technical data are average production values and may vary slightly in individual cases. Subject to change without notice, no guarantee for misprints or errors.